

# COUNTER

## DHC6J-Z

## DIGITAL TACHOMETER

## DHC6J-X



DIN 48×96mmSIZE

0.56 INCH LED DISPLAY

### SPECIFICATIONS

- **Supply Voltage:** AC/DC 100V~240V  
OR (AC/DC 12~24V)
- **Accuracy:** 0.1%FS
- **Digit display:** 0.56 Inch LED
- **Panel cutout:** 45×92mm
- **Weight:** 0.3kg
- **External power supply:** DC12V 30mA (max)
- **Input signals voltage:** L=0~2V  
H=4~30V
- **Power consumption:** ≤4VA
- **Input resistance** Approx 4.7kΩ
- **Temperature:** -10~40°C

### RPM/RPS SETTING

	<p>2, 3 JUMP:RPM *INPUT SIGNAL MIN 12RPM。</p>		<p>1, 2 JUMP:RPS * INPUT SIGNAL MIN 0.2RPS</p>
---	---	---	--

### DIMENSIONS

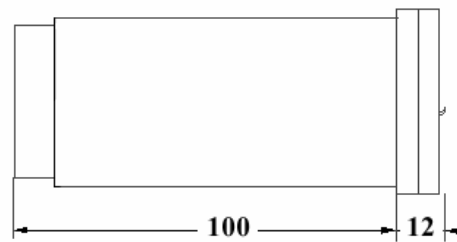
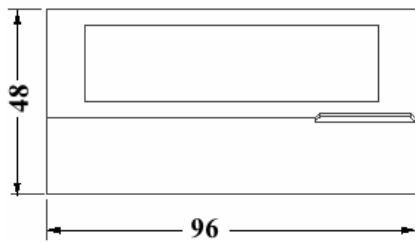

### CONNECTIONS

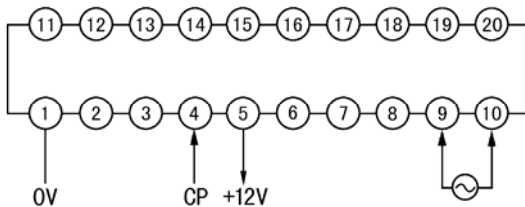

### SETTING

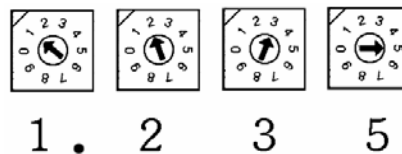

### Signal Input:

